

Pre-Insulated Pipe Supports



INDEX

Contents	Page Number
Clement Support Services General Information.....	1
Pre-insulated Specifications.....	2– 3
Pre-insulated Pricing.....	4 – 5
Pipe Hanger Sizing Chart.....	6
Pipe Insulation Dimensional Data	7
Strut Clamp Sizing For Pre-Insulated Supports.....	8
Pre-Insulated Product Warranty	9

Clement Support Services General Information:

Clement Support Services, Inc. are the pipe support leaders in design, supply, fabrication, and service bringing to the market place over 100 years of combined pipe support knowledge to work for YOU. Our projects are broad ranged from small schools to multi-million dollar hospitals and water treatment plants. We provide the most complete pipe support packages available in the market place today. CSS Inc. is a full inventoried pipe support hanger supplier. We specialize in fabricated pipe supports and have the best, most economical, seismic bracing packages available on the market today.

Our capabilities are vast but can be summarized as follows:

Engineering Services:

Clement Support Services can offer engineering support with design, layout and structural calculations and can assist in the following areas:

- Take off and pre-bid quotes
- Engineering Services including design, layout, and calculations
- Value added design services - AutoCAD
- File transfer protocol (FTP) - easily upload large project files and exchange data.
- Seismic Bracing Solutions - Riser Shafts, Roof support, Thermal Anchor Guides and Equipment
- Thermal Pipe Analysis
- Retrofit Applications

Hangers, Hardware, Pre-Insulated Supports and Seismic Bracing:

We are specialists in seismic bracing design, supply, service, and support. We can handle seismic bracing projects of any size in any location. We carry a large inventory of our pre-insulated supports which are made of ASBESTOS FREE Calcium Silicate, treated for water resistance, encased in a 360 degree A-527 Galvanized Sheet Metal jacket. The calcium silicate is a minimum 100PSI compressive strength. While carrying the largest inventory of hanger products in California, Clement Support has the ability to deliver products on time to meet your fast paced project requirements. In addition to our standard product, Clement Support can meet any special requirements and has the industry expertise to assist with any specific requests. Our inventory for hangers and hardware includes products in many finishes including electro plated, plain, fiberglass, 304/316SS, and Hot Dipped Galvanized.

Fabrication:

Clement Support Services, Inc. (CSS Inc.) is well known in the Waterworks arena due to our extensive capabilities for providing complete support design and supply packages and our extensive project management capabilities from project takeoff/bid to project close/final delivery for waterworks projects of any size ranging from the largest multi-million dollar water and wastewater treatment facilities to the smallest pump stations. Complete support packages often include large and small bore support requirements consisting of stainless steel (304 and 316), hot dip galvanized, plain finish, painted, and FRP materials. All support requirements are supplied from strut, hangers and anchors to large fabricated steel structures, pipe bridges and all types of steel pipe supports.

Crush-resistant insulation for use at the point of support



Model "HW"
Suitable for hot or cold applications

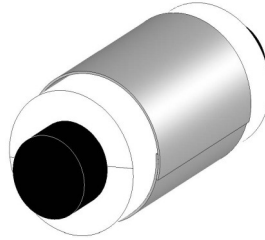

Model "CW"
For applications requiring a wet lag
Insulation extends 1" beyond sheet metal



Model "HWXR/CWXR"
Suitable for hot or cold applications

ASBESTOS FREE Calcium Silicate (Cellular Glass and Polyurethane also available upon request), treated for water resistance, encased in a 360 degree A-653 Galvanized Sheet Metal jacket (304SS and 316SS available upon request). Minimum 140PSI compressive strength. Working Temperature is 42 to 1200 degrees F. Lower temps upon request.

INSULATION LENGTH SPECIFICATION

I.P.S. NOMINAL	Insulation Thickness					
	1"	1 ½"	2"	2 ½"	3"	4"
½" to 1 ½"	4*	4*	4*	4*	6	6
2"	6	6	6	6	6	6
2 ½" to 6"	6	6	6	6	9	9
8" to 10"	9	9	9	9	9	9
12" to 18"	12	12	12	12	12	12
20" to 24"***	18	18	18	18	18	18
*CW Model Inserts have a minimum length of 6"/**Larger Sizes Available Upon Request						

SHEET METAL GAUGE¹

I.P.S. NOMINAL	Insulation Thickness					
	1"	1 ½"	2"	2 ½"	3"	4"
½" to 1 ½"	24	24	24	20	20	20
2"	20	20	20	20	20	20
2 ½" to 5"	20	20	20	20	20	20
6"	20	20	20	20	16	16
8" to 24"	16	16	16	16	16	16

¹ A double thickness of sheet metal is recommended on the lower half when used with rollers or when hanger span exceeds ten feet.



HW

Our Model "HW" insulated support. Works equally well on both hot and cold lines. For standard lengths and sheet metal gauges see the specification sheet. Special order insulation lengths and metal gauges are available upon request. To order with double sheet metal use part number "HWX" and with load bearing plates use "HWXR/CWXR".

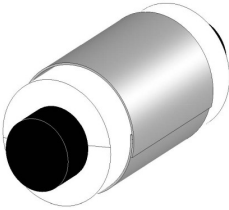

CW

Our Model "CW" insulated support. Originally designed for use in wet lag applications. We continue to provide this model for use in wet lag situations and per specification. See Specification sheet for standard dimensions and metal gauges. The minimum length for our "CW" insert is 6". This model is also available with double metal "CWX", and with load bearing plates, model "HWXR/CWXR".



HWXR/CWXR

Our Model "HWXR" insulated support. See Specification sheet for standard dimensions and metal gauges. Special order insulation lengths and metal gauges are available upon request. This model comes with double sheet metal and rolled plates. Available in hot and cold models.

MAXIMUM ALLOWABLE LOAD

Load ratings shown are in LBS. and are assuming all HW/CW and HWX/CWX models are mounted in a clevis hanger. Load ratings for HWXR/CWXR are assuming flat surface mounting method. If alternate mounting methods are desired please contact the factory for load capacity information and a custom submittal for your project.

Pipe Size	HW/CW	HWX/CWX	HWXR/CWXR
½"	51	57	49
¾"	62	62	57
1"	72	77	68
1 ¼"	92	102	95
1 ½"	123	133	125
2"	164	174	165
2 ½"	225	245	225
3"	276	306	276
4"	388	419	388
5"	500	531	500
6"	612	633	551
8"	827	888	694
10"	1102	1214	714
12"	1326	1428	1020
14"	1541	1653	1102
16"	1765	1867	1214
18"	1979	2091	1326
20"	2204	2306	1428
24"	2530	2642	1541

List Price Effective May 1, 2010

MODEL "HW"

IRON PIPE SIZE	INSULATION THICKNESS								COPPER TUBE OD
	½"	1"	1 ½"	2"	2 ½"	3"	3 ½"	4"	
½"	\$4.84	\$3.52	\$4.59	\$5.93	\$9.47	\$14.76	\$20.71	\$27.84	⅝"
¾"	\$4.97	\$3.54	\$4.62	\$6.11	\$10.15	\$16.20	\$22.04	\$27.88	⅞"
1"	\$5.28	\$3.73	\$4.91	\$6.46	\$10.54	\$16.43	\$22.05	\$27.91	1 ⅛"
1 ¼"	\$5.36	\$3.92	\$5.01	\$6.96	\$10.95	\$17.08	\$22.09	\$28.89	1 ⅜"
1 ½"	\$5.43	\$4.05	\$5.12	\$7.45	\$11.51	\$19.35	\$22.99	\$31.03	1 ⅝"
2"	\$8.68	\$5.93	\$7.83	\$11.16	\$17.43	\$20.72	\$24.79	\$31.54	2 ⅛"
2 ½"	\$9.56	\$6.51	\$9.02	\$13.08	\$19.03	\$29.71	\$42.35	\$54.14	2 ⅜"
3"	\$10.27	\$7.26	\$9.41	\$13.83	\$21.00	\$31.32	\$44.05	\$55.58	3- ⅛"
3 ½"	\$8.70	\$8.70	\$10.71	\$15.51	\$24.67	\$36.24	\$49.69	\$61.54	
4"	\$12.08	\$8.84	\$10.71	\$15.51	\$24.67	\$39.32	\$51.95	\$65.26	4 ⅛"
5"	\$13.08	\$10.26	\$13.12	\$18.52	\$29.55	\$49.93	\$56.52	\$70.65	5 ⅛"
6"	\$15.81	\$11.56	\$13.47	\$21.01	\$34.67	\$52.51	\$61.91	\$76.14	6 ⅛"
8"	\$93.22	\$24.58	\$25.89	\$39.67	\$50.98	\$60.15	\$73.15	\$93.22	
10"	\$107.18	\$32.42	\$33.38	\$46.26	\$61.20	\$71.75	\$90.98	\$107.18	
12"	\$158.56	\$50.73	\$53.67	\$63.43	\$83.27	\$107.41	\$134.37	\$158.56	
14"	\$162.78	\$66.39	\$67.55	\$82.91	\$101.02	\$119.00	\$144.08	\$162.78	
16"	\$194.09	\$78.28	\$79.72	\$95.95	\$121.47	\$136.25	\$181.19	\$194.09	
18"	\$213.08	\$86.68	\$87.98	\$104.94	\$129.88	\$149.30	\$196.99	\$213.08	

MODEL "CW"

IRON PIPE SIZE	INSULATION THICKNESS								COPPER TUBE OD
	½"	1"	1 ½"	2"	2 ½"	3"	3 ½"	4"	
½"	\$5.78	\$4.50	\$5.34	\$7.87	\$11.42	\$14.47	\$20.29	\$27.29	⅝"
¾"	\$5.92	\$4.55	\$5.48	\$8.50	\$11.51	\$15.88	\$21.59	\$27.32	⅞"
1"	\$6.08	\$4.67	\$5.89	\$8.72	\$12.76	\$16.10	\$21.61	\$27.35	1 ⅛"
1 ¼"	\$6.38	\$4.69	\$6.41	\$9.34	\$13.21	\$16.74	\$21.64	\$28.31	1-⅜"
1 ½"	\$6.45	\$4.74	\$6.54	\$9.99	\$14.29	\$18.96	\$22.53	\$30.41	1 ⅝"
2"	\$8.68	\$5.93	\$7.83	\$11.16	\$17.43	\$20.72	\$24.79	\$31.54	2 ⅛"
2 ½"	\$9.56	\$6.51	\$9.02	\$13.08	\$19.03	\$29.71	\$42.35	\$54.14	2 ⅜"
3"	\$10.27	\$7.26	\$9.41	\$13.83	\$21.00	\$31.32	\$44.05	\$55.58	3 ⅛"
3 ½"	\$8.70	\$8.70	\$10.71	\$15.51	\$24.67	\$36.24	\$49.69	\$61.54	
4"	\$12.08	\$8.84	\$10.71	\$15.51	\$24.67	\$39.32	\$51.95	\$65.26	4 ⅛"
5"	\$13.08	\$10.26	\$13.12	\$18.52	\$29.55	\$49.93	\$56.52	\$70.65	5 ⅛"
6"	\$15.81	\$11.56	\$13.47	\$21.01	\$34.67	\$52.51	\$61.91	\$76.14	6 ⅛"
8"	\$93.22	\$24.58	\$25.89	\$39.67	\$50.98	\$60.15	\$73.15	\$93.22	
10"	\$107.18	\$32.42	\$33.38	\$46.26	\$61.20	\$71.75	\$90.98	\$107.18	
12"	\$158.56	\$50.73	\$53.67	\$63.43	\$83.27	\$107.41	\$134.37	\$158.56	
14"	\$162.78	\$66.39	\$67.55	\$82.91	\$101.02	\$119.00	\$144.08	\$162.78	
16"	\$194.09	\$78.28	\$79.72	\$95.95	\$121.47	\$136.25	\$181.19	\$194.09	
18"	\$213.08	\$86.68	\$87.98	\$104.94	\$129.88	\$149.30	\$196.99	\$213.08	

Pipe/Conduit Supports - Strut Systems - Seismic Design & Material - Fabrication - Engineering

Corporate Office ♦ 480 Vandell Way ♦ Campbell, CA 95008 ♦ Tel: 408.227.1171 ♦ Fax: 408.227.1178 ♦ www.clementsupport.com

List Price Effective May 1, 2010

MODEL "HWX"

IRON PIPE SIZE	INSULATION THICKNESS								COPPER TUBE OD
	½"	1"	1 ½"	2"	2 ½"	3"	3 ½"	4"	
½"	\$6.06	\$4.40	\$5.74	\$7.42	\$11.84	\$18.45	\$25.89	\$34.80	⅝"
¾"	\$6.21	\$4.43	\$5.77	\$7.64	\$12.68	\$20.26	\$27.55	\$34.85	⅞"
1"	\$6.59	\$4.66	\$6.14	\$8.08	\$13.17	\$20.54	\$27.56	\$34.88	1 ⅛"
1 ¼"	\$6.70	\$4.90	\$6.26	\$8.70	\$13.69	\$21.35	\$27.61	\$36.12	1 ⅜"
1 ½"	\$6.78	\$5.06	\$6.40	\$9.31	\$14.39	\$24.19	\$28.73	\$38.79	1 ⅝"
2"	\$10.85	\$7.42	\$9.79	\$13.95	\$21.79	\$25.90	\$30.99	\$39.42	2 ⅛"
2 ½"	\$11.95	\$8.14	\$11.27	\$16.35	\$23.78	\$37.14	\$52.94	\$67.68	2 ⅜"
3"	\$12.84	\$9.08	\$11.76	\$17.28	\$26.25	\$39.15	\$55.06	\$69.48	3 ⅛"
3 ½"	\$10.88	\$10.88	\$13.39	\$19.39	\$30.83	\$45.30	\$62.11	\$76.93	
4"	\$15.10	\$11.05	\$13.39	\$19.39	\$30.83	\$49.15	\$64.94	\$81.58	4 ⅛"
5"	\$16.35	\$12.82	\$16.40	\$23.15	\$36.94	\$62.41	\$70.65	\$88.31	5 ⅛"
6"	\$19.77	\$14.45	\$16.84	\$26.26	\$43.34	\$65.64	\$77.39	\$95.18	6 ⅛"
8"	\$116.52	\$30.72	\$32.37	\$49.59	\$63.72	\$75.19	\$91.44	\$116.52	
10"	\$133.98	\$40.53	\$41.73	\$57.83	\$76.50	\$89.69	\$113.72	\$133.98	
12"	\$198.19	\$63.41	\$67.09	\$79.28	\$104.09	\$134.26	\$167.96	\$198.19	
14"	\$203.48	\$82.98	\$84.44	\$103.64	\$126.28	\$148.75	\$180.10	\$203.48	
16"	\$242.61	\$97.85	\$99.65	\$119.94	\$151.83	\$170.32	\$226.48	\$242.61	
18"	\$266.35	\$108.35	\$109.98	\$131.18	\$162.35	\$186.62	\$246.23	\$266.35	

MODEL "CWX"

IRON PIPE SIZE	INSULATION THICKNESS								COPPER TUBE OD
	½"	1"	1 ½"	2"	2 ½"	3"	3 ½"	4"	
½"	\$7.23	\$5.63	\$6.67	\$9.84	\$14.28	\$18.09	\$25.36	\$34.11	⅝"
¾"	\$7.40	\$5.69	\$6.85	\$10.63	\$14.39	\$19.84	\$26.99	\$34.16	⅞"
1"	\$7.61	\$5.83	\$7.37	\$10.89	\$15.95	\$20.13	\$27.01	\$34.19	1 ⅛"
1 ¼"	\$7.97	\$5.87	\$8.02	\$11.67	\$16.51	\$20.92	\$27.06	\$35.39	1 ⅜"
1 ½"	\$8.06	\$5.93	\$8.18	\$12.49	\$17.87	\$23.70	\$28.16	\$38.01	1 ⅝"
2"	\$10.85	\$7.42	\$9.79	\$13.95	\$21.79	\$25.90	\$30.99	\$39.42	2 ⅛"
2 ½"	\$11.95	\$8.14	\$11.27	\$16.35	\$23.78	\$37.14	\$52.94	\$67.68	2 ⅜"
3"	\$12.84	\$9.08	\$11.76	\$17.28	\$26.25	\$39.15	\$55.06	\$69.48	3 ⅛"
3 ½"	\$10.88	\$10.88	\$13.39	\$19.39	\$30.83	\$45.30	\$62.11	\$76.93	
4"	\$15.10	\$11.05	\$13.39	\$19.39	\$30.83	\$49.15	\$64.94	\$81.58	4 ⅛"
5"	\$16.35	\$12.82	\$16.40	\$23.15	\$36.94	\$62.41	\$70.65	\$88.31	5 ⅛"
6"	\$19.77	\$14.45	\$16.84	\$26.26	\$43.34	\$65.64	\$77.39	\$95.18	6 ⅛"
8"	\$116.52	\$30.73	\$32.37	\$49.59	\$63.72	\$75.19	\$91.44	\$116.52	
10"	\$133.98	\$40.53	\$41.73	\$57.83	\$76.50	\$89.69	\$113.72	\$133.98	
12"	\$198.19	\$63.41	\$67.09	\$79.28	\$104.09	\$134.26	\$167.96	\$198.19	
14"	\$203.48	\$82.98	\$84.44	\$103.64	\$126.28	\$148.75	\$180.10	\$203.48	
16"	\$242.61	\$97.85	\$99.65	\$119.94	\$151.83	\$170.32	\$226.48	\$242.61	
18"	\$266.35	\$108.35	\$109.98	\$131.18	\$162.35	\$186.62	\$246.23	\$266.35	

Pipe/Conduit Supports - Strut Systems - Seismic Design & Material - Fabrication - Engineering

Corporate Office ♦ 480 Vandell Way ♦ Campbell, CA 95008 ♦ Tel: 408.227.1171 ♦ Fax: 408.227.1178 ♦ www.clementsupport.com

PIPE HANGER SIZING CHART

IRON PIPE SIZE	INSULATION THICKNESS					
	½"	1"	1 ½"	2"	2 ½"	3"
½"	1 ½"	2 ½"	3 ½"	5"		
¾"	2"	2 ½"	3 ½"	5"	6"	8"
1"	2"	3"	4"	5"	6"	8"
1 ¼"	2 ½"	3"	5"	5"	6"	8"
1 ½"	3"	3 ½"	5"	6"	8"	8"
2"	3"	4"	5"	6"	8"	8"
2 ½"	3 ½"	5"	6"	8"	8"	10"
3"	4"	5"	6"	8"	8"	10"
4"	5"	6"	8"	8"	10"	10"
5"	6"	8"	8"	10"	10"	12"
6"	8"	8"	10"	10"	12"	12"
8"		10"	12"	12"	14"	16"
10"		12"	14"	16"	16"	18"
12"		16"	16"	18"	18"	20"

COPPER TUBE OD	INSULATION THICKNESS					
	½"	1"	1 ½"	2"	2 ½"	3"
½"	1 ½"	2 ½"	3 ½"	4"		
⅝"	1 ½"	2 ½"	3 ½"	5"	6"	8"
1 ⅛"	2"	2 ½"	3 ½"	5"	6"	8"
1 ⅜"	2"	3"	4"	5"	6"	8"
1 ⅝"	2 ½"	3"	5"	5"	6"	8"
2 ⅛"	3"	3 ½"	5"	6"	8"	8"
2 ⅜"	3"	4"	5"	6"	8"	8"
3 ⅛"	3 ½"	5"	6"	8"	8"	10"
4 ⅛"	5"	6"	8"	8"	10"	10"
5 ⅛"	6"	8"	8"	10"	10"	12"
6 ⅛"	6"	8"	10"	10"	12"	12"

PIPE INSULATION DIMENSIONAL DATA

O.D. Insulation (in.)

IRON PIPE SIZE	ACTUAL PIPE OD	INSULATION THICKNESS					
		½"	1"	1 ½"	2"	2 ½"	3"
¾"	1.05	2.16	2.82	3.95	4.95		
1"	1.315	2.41	3.45	4.45	5.51		
1 ¼"	1.66	2.72	3.45	4.95	5.51		
1 ½"	1.99	2.99	3.95	4.95	6.57	7.57	8.57
2"	2.375	3.42	4.45	5.51	6.57	7.57	8.57
2 ½"	2.875	3.93	4.95	6.57	7.57	8.57	9.57
3"	3.5	4.56	5.51	6.57	7.57	8.57	9.57
3 ½"	4	5.07	6.57	7.57	8.57	9.57	10.7
4"	4.5	5.57	6.57	7.57	8.57	9.57	10.7
5"	5.563	6.64	7.57	8.57	9.57	10.7	11.7
6"	6.625	7.71	8.57	9.57	10.7	11.7	12.7
8"	8.625	9.74	10.7	11.7	12.7	13.95	14.95
10"	10.75	11.87	12.7	13.95	14.95	15.95	16.95
12"	12.75	13.88	14.95	15.95	16.95	17.95	18.95

COPPER TUIBE OD		INSULATION THICKNESS					
½"	⅝"	1.66	2.82	3.45			
¾"	⅞"	1.92	2.82	3.95	4.95		
1"	1 ⅛"	2.16	2.82	3.95	4.95		
1 ¼"	1 ⅜"	2.41	3.45	4.45	5.51		
1 ½"	1 ⅝"	2.72	3.45	4.95	5.51		
2"	2 ⅛"	3.16	3.95	4.95	6.57	7.57	8.57
2 ½"	2 ⅝"	3.66	4.45	5.51	6.57	7.57	8.57
3"	3 ⅛"	4.16	4.95	6.57	7.57	8.57	9.57
4"	4 ⅛"	5.16	6.57	7.57	8.57	9.57	10.7
5"	5 ⅛"	6.16	7.57	8.57	9.57	10.7	11.7
6"	6 ⅛"	7.16	8.57	9.57	10.7	11.7	12.7

STRUT CLAMP SIZING FOR PRE-INSULATED SUPPORTS

IRON PIPE SIZE	INSULATION THICKNESS			
	½"	1"	1 ½"	2"
½"	1 ½" RIGID	3" OD	4 ⅛" OD	5 ⅛" OD
¾"	2 ⅛" OD	3" OD	4 ⅛" OD	5 ⅛" OD
1"	2" RIGID	3 ⅝" OD	4" RIGID	5 ¾" OD
1 ¼"	2 ⅝" OD	3 ⅝" OD	5 ⅛" OD	5 ¾" OD
1 ½"	3 ⅛" OD	4 ⅛" OD	5 ⅛" OD	6 ¾" OD
2"	3 ⅝" OD	4 ⅝" OD	5" RIGID	6 ¾" OD
2 ½"	4 ⅛" OD	5 ⅝" OD	6 ¾" OD	7 ¾" OD
3"	4" RIGID	5 ¾" OD	6 ¾" OD	7 ¾" OD
3 ½"	5" OD	6 ¾" OD	7 ¾" OD	8 ¾" OD
4"	5" RIGID	6 ¾" OD	7 ¾" OD	8 ¾" OD
5"	-	7 ¾" OD	8 ¾" OD	9 ¾" OD
6"	-	8 ¾" OD	9 ¾" OD	10" RIGID
8"	-	10" RIGID	12" OD	12" RIGID
10"	-	12" RIGID	14 ¼" OD	15 ¼" OD
12"	-	15 ¼" OD	16" RIGID	17 ¼" OD

COPPER TUBE OD PIPE	INSULATION THICKNESS			
	½"	1"	1 ½"	2"
⅝"	1 ⅝" OD	2 ¾" OD	3 ⅝" OD	4 ⅝" OD
⅞"	1 ½" RIGID	3" OD	4 ⅛" OD	5 ⅛" OD
1 ⅛"	2 ⅛" OD	3" OD	4 ⅛" OD	5 ⅛" OD
1 ⅜"	2" RIGID	3 ⅝" OD	4 ⅝" OD	5 ¾" OD
1 ⅝"	2 ⅝" OD	3 ⅝" OD	5 ⅛" OD	5 ¾" OD
2 ⅛"	3 ⅛" OD	4 ⅛" OD	5 ⅛" OD	6 ¾" OD
2 ⅝"	3 ⅝" OD	4 ⅝" OD	5 ¾" OD	6 ¾" OD
3 ⅛"	4 ⅛" OD	5 ⅝" OD	6 ¾" OD	7 ¾" OD
4 ⅛"	5 ⅝" OD	6 ¾" OD	6 ¾" OD	7 ¾" OD
5 ⅝"	-	7 ¾" OD	8 ¾" OD	9 ¾" OD
6 ⅝"	-	8 ¾" OD	9 ¾" OD	10" RIGID

Pre-Insulated Product Warranty

Clement Support Services, Inc. warrants for one (1) year from the date of delivery each Pre-Insulated product to be free from defects in materials and workmanship when used for the purpose recommended.

In the event any installed product is found to be defective, and is covered under this warranty, the owner should contact Clement Support Services Inc. immediately. The owner will be instructed to return the defective product at their own expense for inspection. The warranty is then limited to the repair or replacement of those products that Clement Support Services, Inc. determines, to their satisfaction, are defective and Clement Support Services Inc. shall not be liable for any charge or expense incurred by the owner in repairing or replacing said products.



Branch / Sales Locations

CORPORATE OFFICE

480 Vandell Way
Campbell, CA 95008
Tel: 408-227-1171
Fax: 408-227-1178

SACRAMENTO BRANCH

8790 Fruitridge Road
Sacramento, CA 95826
Tel: 916-388-7800
Fax: 916-388-1401

LA MIRADA BRANCH

15020 Desman Road
La Mirada, CA 90638
Tel: 562-946-1808
Fax: 714-562-0757

SEATTLE OFFICE

815 1st Avenue, #163
Seattle, WA 98104
Tel: 206-323-7322
Fax: 206-323-7327